

PIIONEER

PELLET MILL

**NEW
MODEL
B-200B-350**



BLISS
INDUSTRIES, LLC.

Impacting Industries Worldwide.

Developed from a design concept proven worldwide since its introduction in 1975, the range of Pioneer Pellet Mills continues to expand. Design features such as overall reliability, maximum efficiency, ease of operation and maintenance combine to provide lower operating costs to each owner. With the ability to provide a wide range of die sizes, die speeds and drive power, Bliss can more than meet your requirements for high quality at a reasonable cost.

PELLETING CHAMBER

The stainless steel pelleting chamber door can be hinged to the left or right, as your needs require. Easily adjusted, calibrated knives are fitted to the door for control over pellet length. Safety switches are integrated into the design to protect the operator from opening the door while the machine is in operation.

BY-PASS CHUTE

To prevent blockages of the die and to avoid an overload on the main drive, a by-pass chute is standard equipment. Fitted with an electrically controlled air cylinder, virtually all overloads and blockages can be eliminated.

ROLL ADJUSTMENT SYSTEM

Ease of manual roll adjustment is an essential feature of all Pioneer Pellet Mills. Quick-release rolls for ease of clearing plugs from pelleting chamber.

DIES

Pioneer Pellet Mills use easily reversible dies, promoting uniform wear on the die track, resulting in longer working life.

ALTERNATE DOOR

An alternate door is provided for quick access to the pelleting chamber.



DIE HOIST

An integral hoist permits the easy handling of dies, rolls, front plate and rotary feed cone.

SPACE SAVING DESIGN

Motors mounted above the robust, fabricated steel body produce a space saving design.

BELT DRIVE TRANSMISSION

Shock-absorbing belts form the first stage of the Pioneer drive transmission with a hydraulic or mechanical system constantly maintaining the correct tension. With this method, slippage is eliminated and the belts have a longer operational life.

TWO-STAGE TWIN DRIVE

The patented two-stage drive system forms the basis for ideal transmission ratios. The combination of resilient V-belts with a high torque cog belt reduces the noise level, allows the use of standard electric motors and permits the selection of a range of die speeds.

FEED CONE SYSTEM

The balance and consistency of the Bliss pelleting chamber produces “even striations” throughout the body of the pellet. The result is uniform wear within the pelleting chamber and a higher quality finished product.

Pellet Side View

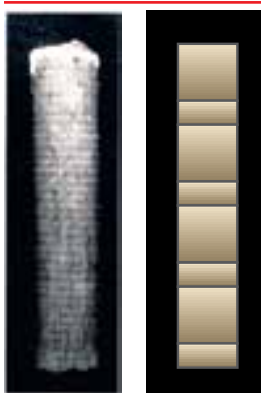

BLISS

OTHERS

OVERLOAD PROTECTION

The die and roller assembly is protected by a hydraulic or mechanical overload system which stops the main motors when an overload situation occurs. Re-setting is quick and easy.

AUTOMATIC LUBRICATION

The Bliss Pioneer Pellet Mill uses an automatic lubrication system to ensure that roller and main shaft bearings receive proper lubrication at all times during operation of the pellet mill.

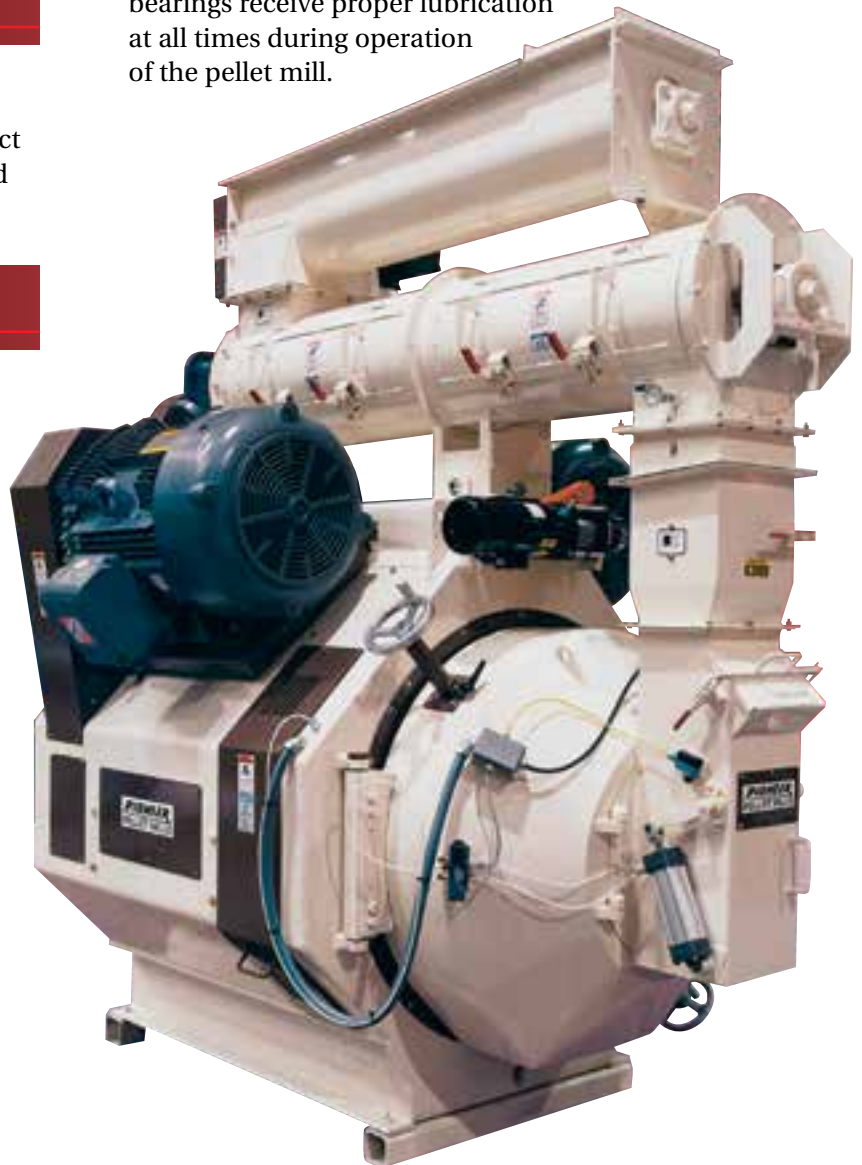

Impacting Industries Worldwide.

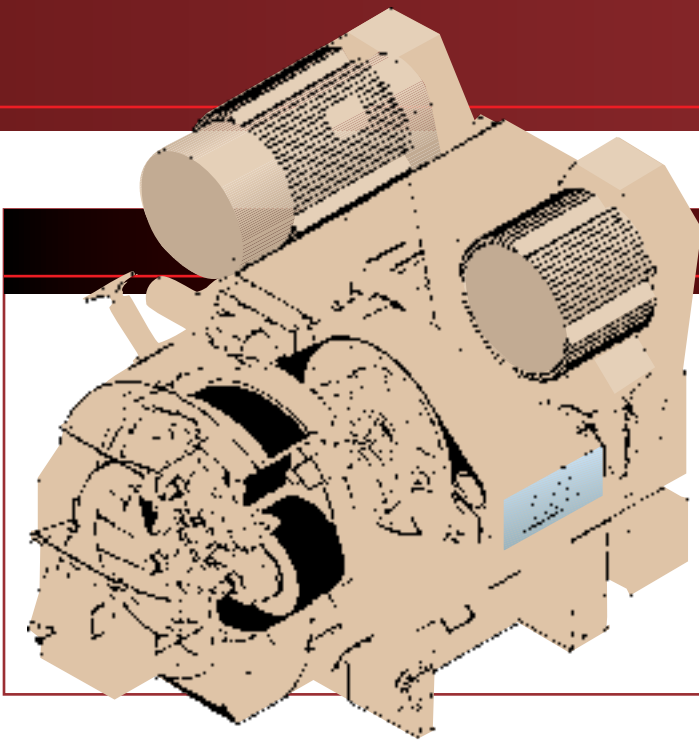

INCREASED UP-TIME

Nothing is more important to your business than long term performance. All interior components of a Bliss Pellet Mill are selected for superior performance and wear. The result is maximum up-time that increases revenue and diminishes the chances of premature component failure.



FEEDER/CONDITIONER SYSTEM

The Bliss Feeder/Conditioner features fully adjustable picks that enable you to control the retention time of the product prior to pelleting. The unit features oversize side access doors for unobstructed access to all working components.

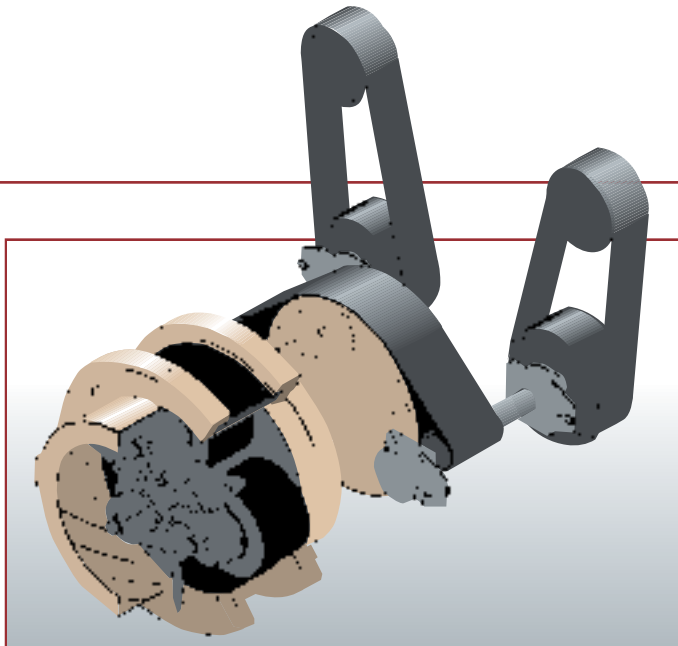

BELT DRIVE TRANSMISSION

The Belt Drive Transmission will net the proper gear reduction to attain desired die speeds. Please note that the style of the Pioneer belt drive transmission offers the most compact design available.



INDUSTRIAL STRENGTH EQUIPMENT



HAMMERMILL



PELLET MILL



OP<FLO COOLER



CRUMBLER

GENERAL DIMENSIONS



Impacting Industries Worldwide.

Overall reliability

Maximum efficiency

Ease of operation

Ease of maintenance

Lower operating costs

Wide range of die sizes,
die speeds and drive power

Reasonable cost

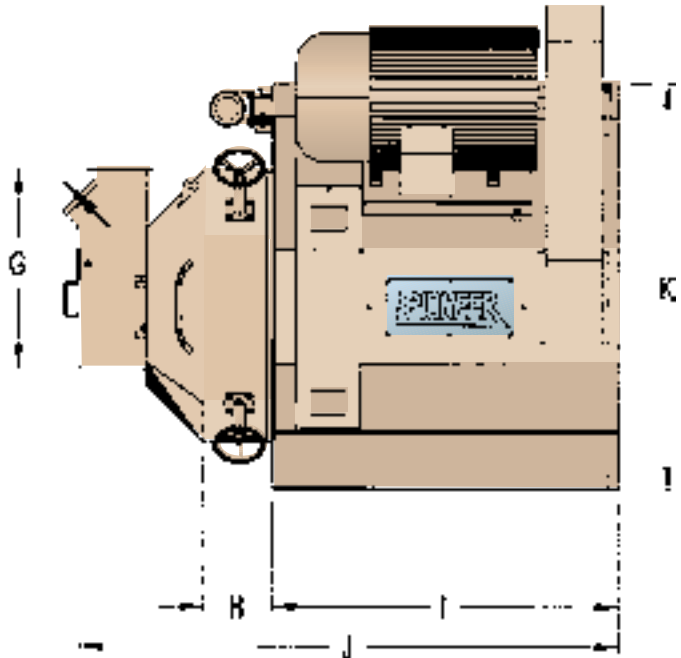
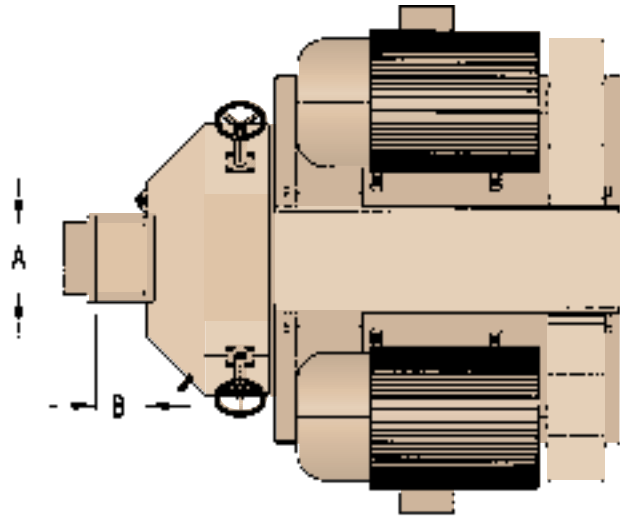
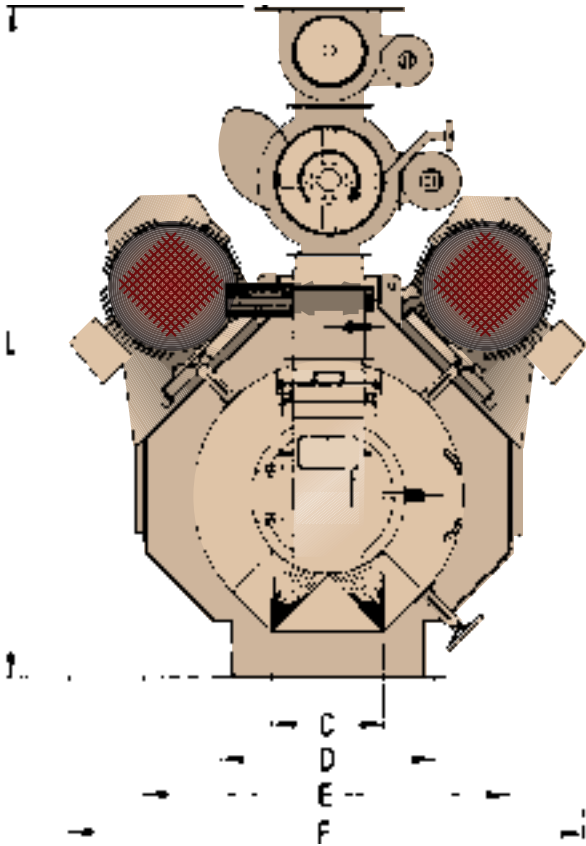

GENERAL PELLET MILL DIMENSIONS

MODEL	A	B	C	D	E	F	G	H	I	J	K	L
35B-105	10-7/8	7	14-7/8	38-1/2	41-1/2	65-3/4	27-1/2	7-1/2	42	64-5/8	47-7/8	92
60B-170	10-1/4	7-1/4	16-1/8	36-1/4	59-7/8	81	26-1/4	8-5/8	56-7/8	82-1/2	55-5/8	110
120B-175	11-7/8	8-5/8	19-1/4	37	63	100	34	10-7/8	59	92	69-1/4	119
200B-350	16	11-7/8	23-3/8	60-5/8	63	100	40-7/8	22-13/16	59	106-9/16	69-1/4	138-1/4

* Dimensions are intended for general use only. Specific drawings available upon request. Dimensions shown are in inches.

SPECIFICATIONS

PELLET MILL

Specifications	B35A-35	B35A-75	B35A-105	B60A-100	B-60A-130
Total Drive Power	60/80 HP	60/80/100/120 HP	80/100/120 HP	100/120/150 HP	100/120/150 HP
Motor Shaft Speed	1200/1800 RPM	1200/1800 RPM	1200/1800 RPM	1200 RPM	1200 RPM
Die I.D. Diameter	17-13/16"	17-13/16"	17-13/16"	21-13/16"	21-13/16"
Die RPM	165/250 RPM	165/250 RPM	165/250 RPM	123/151 RPM	123/151 RPM
Track Speed (FPM)	769/1165 FPM	769/1165 FPM	769/1165 FPM	705/866 FPM	705/866 FPM
Die Track Width	1-3/8"	3"	4-1/8"	3-15/16"	5-1/8"
Number of Rolls	3	3	3	3	3
Roll Diameter	8-1/8"	8-1/8"	8-1/8"	9-3/4"	9-3/4"
Die Area	79 Sq. In.	165 Sq. In.	231 Sq. In.	270 Sq. In.	351 Sq. In.
Roll Area	35 Sq. In.	77 Sq. In.	105 Sq. In.	121 Sq. In.	157 Sq. In.

B-60A-170	B120A-100	B-120A-141	B-120A-175	B-200B-120	B-200B-141
150/200 HP	200/250	200/250 HP	200/250/300 HP	300 - 500 HP	300 - 500 HP
1200 RPM	1200 RPM	1200 RPM	1200 RPM	1200 RPM	1200 RPM
21-13/16"	25-11/16"	25-11/16"	25-11/16"	34-13/16"	34-13/16"
152/219 RPM	140/161 RPM	140/161 RPM	140/161/180 RPM	116/138 RPM	116/138 RPM
866/1,249 FPM	943/1,082 FPM	943/1,082 FPM	943/1,082/1,211 FPM	1,037/1,254 FPM	1,037/1,254 FPM
6-11/16"	3-15/16"	5-9/16"	6-7/8"	4-3/4"	5-9/16"
3	3	3	3	3	3
9-3/4"	11-11/16"	11-11/16"	11-11/16"	15-7/8"	15-7/8"
458 Sq. In.	318 Sq. In.	448 Sq. In.	554 Sq. In.	517 Sq. In.	607 Sq. In.
205 Sq. In.	145 Sq. In.	205 Sq. In.	254 Sq. In.	237 Sq. In.	276 Sq. In.

B-200B-175	B-200B-210	B-200B-250	B-200B-280	B-200B-350	
300 - 500 HP	300 - 500 HP	300 - 500 HP	400 - 500 HP	600 HP	
1200 RPM	1200 RPM	1200 RPM	1200 RPM	1200 RPM	
34-13/16"	34-13/16"	34-13/16"	34-13/16"	34-13/16"	
116/138 RPM	116/138 RPM	156/175 RPM	156/175 RPM	156/175 RPM	
1,037/1,254 FPM	1,037/1,254 FPM	1,421/1,594 FPM	1,421/1,594 FPM	1,421/1,594 FPM	
6-7/8"	8-1/4"	9-7/8"	11"	14"	
3	3	3	3	3	
15-7/8"	15-7/8"	15-7/8"	15-7/8"	15-7/8"	
752 Sq. In.	902 Sq. In.	1,080 Sq. In.	1,203 Sq. In.	1,526 Sq. In.	
345 Sq. In.	413 Sq. In.	492 Sq. In.	548 Sq. In.	681 Sq. In.	Pellet Specs Jan '15

* Specifications are subject to change without obligation or notice.



Impacting Industries Worldwide.

Bliss Industries LLC
 P.O. Box 910 • Ponca City, Oklahoma U.S.A. 74602
 Phone (580) 765-7787 • Fax (580) 762-0111
 Toll Free 1-800-569-7787
 Internet: <http://www.bliss-industries.com>
 E-mail: sales@bliss-industries.com



WARNING LABELS

"Industry Standard" Safety Warning Labels are applied as recommended and prepared by the AFIA Equipment Manufacturers Council.

Represented by:

